

Zeitschrift: IABSE structures = Constructions AIPC = IVBH Bauwerke
Band: 6 (1982)
Heft: C-21: Recent structures

Artikel: The Sports Hall of Lahti (Finland)
Autor: Kruus, J.
DOI: <https://doi.org/10.5169/seals-17582>

Nutzungsbedingungen

Die ETH-Bibliothek ist die Anbieterin der digitalisierten Zeitschriften. Sie besitzt keine Urheberrechte an den Zeitschriften und ist nicht verantwortlich für deren Inhalte. Die Rechte liegen in der Regel bei den Herausgebern beziehungsweise den externen Rechteinhabern. [Siehe Rechtliche Hinweise.](#)

Conditions d'utilisation

L'ETH Library est le fournisseur des revues numérisées. Elle ne détient aucun droit d'auteur sur les revues et n'est pas responsable de leur contenu. En règle générale, les droits sont détenus par les éditeurs ou les détenteurs de droits externes. [Voir Informations légales.](#)

Terms of use

The ETH Library is the provider of the digitised journals. It does not own any copyrights to the journals and is not responsible for their content. The rights usually lie with the publishers or the external rights holders. [See Legal notice.](#)

Download PDF: 15.03.2025

ETH-Bibliothek Zürich, E-Periodica, <https://www.e-periodica.ch>



3. The Sports Hall of Lahti (Finland)

Owner:	<i>Lahden Urheiluhalliyhdistys r.y.</i>
Architect:	<i>Arkkitehtitoimisto Kosti Kuronen Ky</i>
Structural engineer:	<i>Insinööritoimisto Pontek Ky</i>
General contractor:	<i>Rakennustoimisto A. Puolimatka Oy</i>
Construction time:	<i>12 months</i>
Service date:	<i>1981</i>

Introduction

Playing football outdoors in winter time is almost impossible in Finland. The principal aim for building a big sports hall in Lahti is to make football playing possible all year around on a full-size field, thus helping Finnish football closer to the international level. However, for economic reasons, the hall has been planned for multiple use, as it offers already for its site – being situated close to the Salpausselkä winter games center – excellent possibilities for organizing exhibitions, fairs and other events. The hall is in intense use since February 1981.

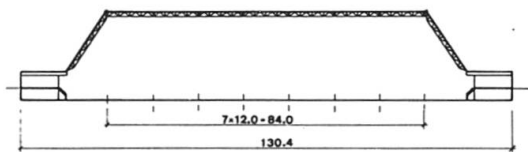

Section

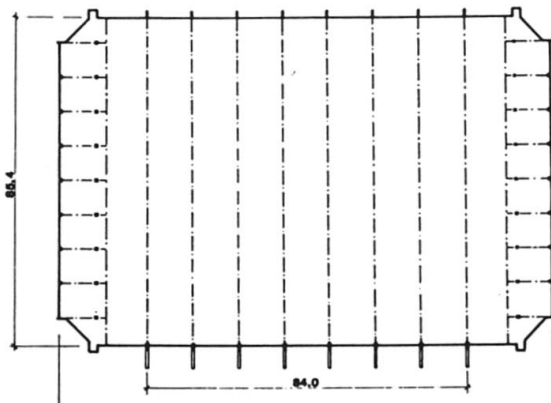

Plan

Choosing the design and material

The design for the contract competition comprised of an arched hall construction with arches in glued laminated wood. The contractor and designers formed a work team which, after examining and analyzing several solutions based on different materials, finally decided on the steel arch construction as the best choice. The proposal was submitted anonymously and, in a tight competition of 12 offerings, it won.

The offerings were evaluated in two stages, firstly, according to the qualifications of the hall in appearance, functionality and technical solutions and secondly, according to the price, that had to be under the prederminate sum of 20 million FIM.

Foundation

The foundation is of reinforced concrete. Reactions of about 2.1 MN from the arches are transferred to the ground by foundation slabs. The allowable stress for the soil varies between 0.3 MPa and 0.6 MPa.

Steel structure

The main structure consists of 8 fixed steel arches. The span of the arches is 84.1 m. The section is a welded I, the height of the web 1,000 mm, the steel quality Raex 384 (yield strength 355 MPa). The secondary structure consists of steel trusses welded from hollow sections, the span 12 m, center space 3 m and height 1,140 mm, steel quality Fe 440, and an arched ceiling of cold-formed folded plate which, supported by the trusses, stiffens them laterally. The folded plate is partly punched with holes for acoustic reasons. The wall structures also are partly in steel.

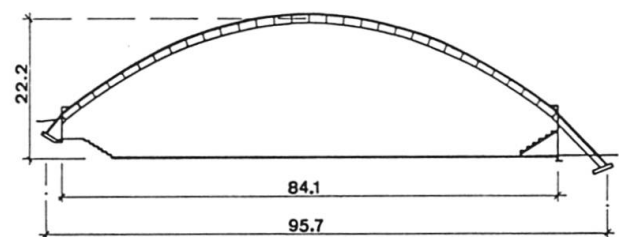

Cross Section

Erection of the steel structure

The steel arches, 92 m of length each, were delivered to the site, each in four parts, two of which were welded together on the ground to a half-arch. Two adjacent arch halves were joined together by the trusses, and plated ready for the erection. The opposite halves were lifted by the cranes, and the top and base joints were adjusted to their places and joined with screws. The secondary trusses and the ceiling plates on the alternate arch spaces as well as all of the heat insulation and the water proofing were installed after erecting the arches.

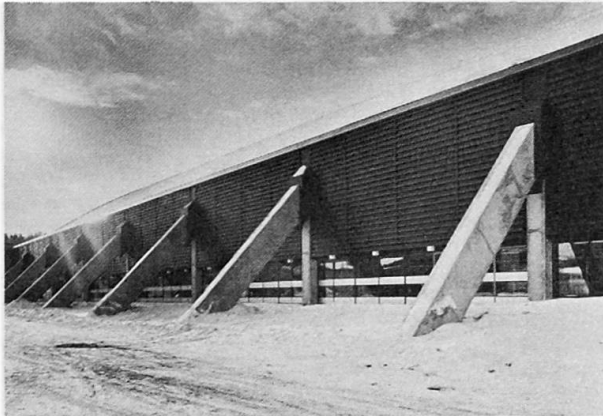

Facade, from the east side



Facade, from the south side

Technical data

Area of the artificial turf: 7,102 m²
Area of the hall: 11,568 m², volume: 163,100 m³
Free height at its most: 21.7 m, on the field side: 12 m
Maximum attendance: 4,000, when in multiple use:
11,000
Temperature: 20 ± 1°C year around
Snow load: 1.8 kN/m², partly: 2.7 kN/m²
Steel consumption; arches: 177 t, trusses and wind
bracings: 99 t.

(J. Kruus)



Interior view of the hall